

Vorhang

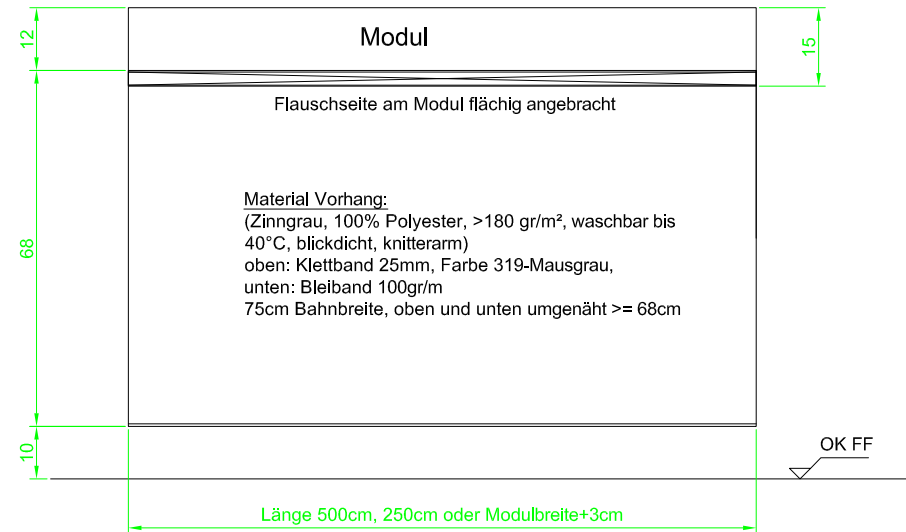

Modulfüsse

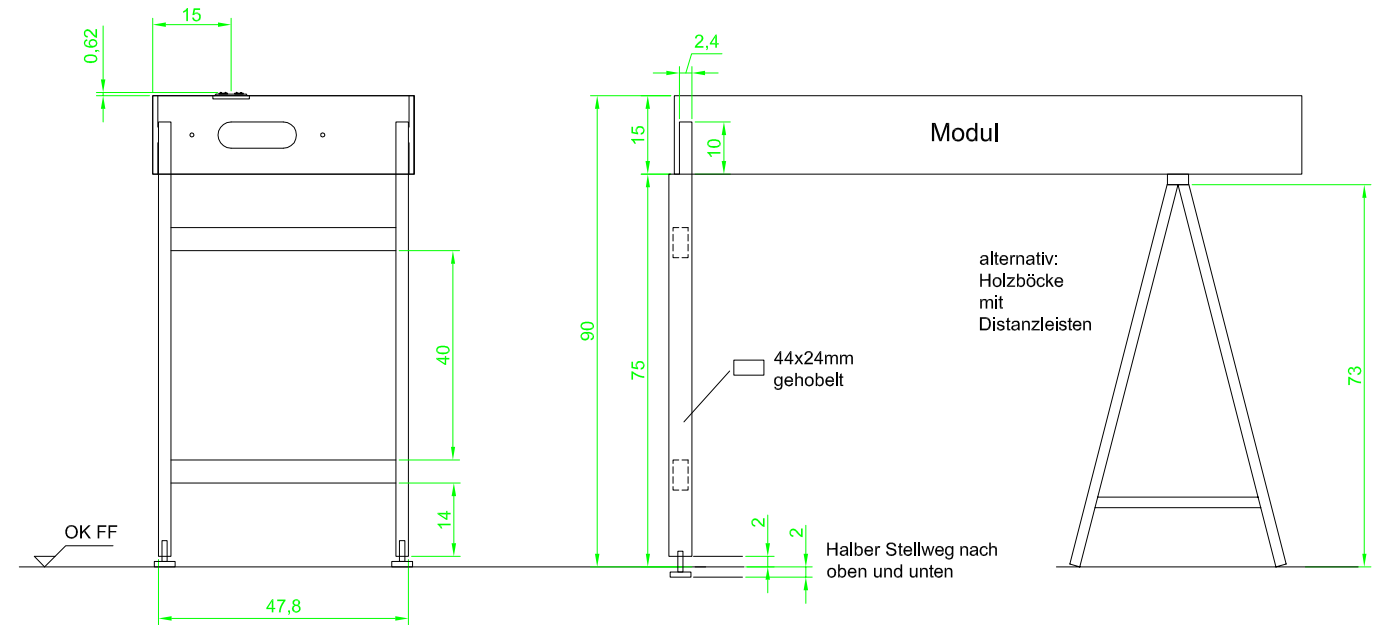

Vorhang Vorderseite

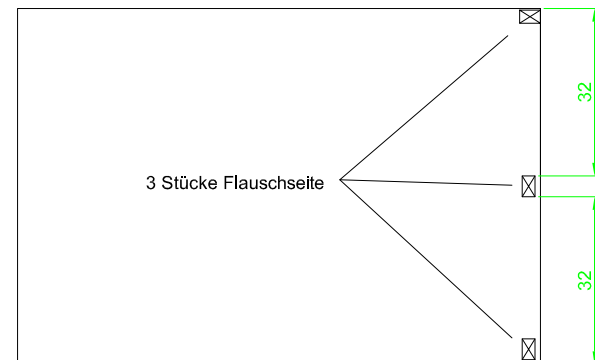

Vorhang Rückseite

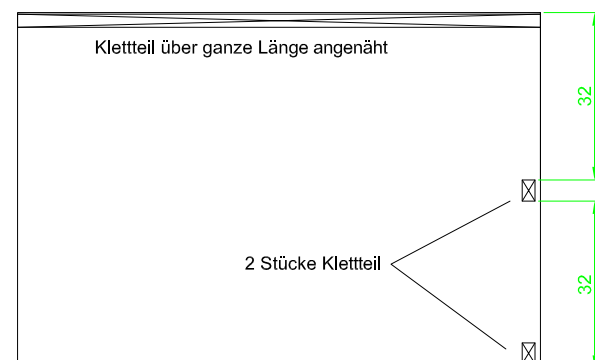

Untersicht Modul

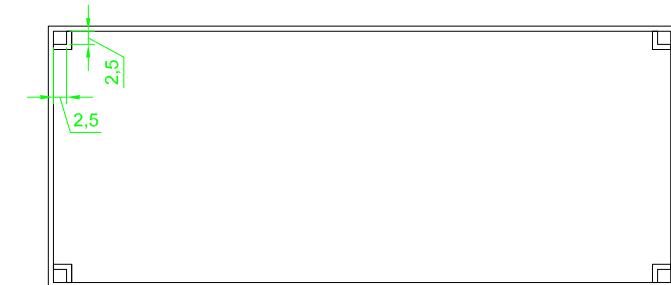

Anmerkungen:

- 1.
- 2.

Stand: 03.06.2014

N-Modul-Bahner Rhein-Main

Aufbau der Module
 Modulfüsse, Vorhang & Höhenjustage

(c) Michael Nowak, Wiesbaden
 gezeichnet am 03. Juni 2014

Maßstab
 o.M.

Blatt
M2

Index
 -